

Customer _____
 Qty. _____
 Date _____

ES-4 or ES-4SS AC/DC MASTER PANEL Order Form

This ES-4 combines multiple AC and DC functions into one compact central load and distribution center for control, protection and monitoring. *Note: There is a modification fee for configurations other than standard.*

OPTIONS:

1) AC Voltmeter

- 0 - 150 VAC (Standard)
- 0 - 3002 VAC (Optional)*

2) AC Ammeter

0 - 50 AAC Only

3) AC Master Breaker*

- 50 Amp (Standard; 115 VAC only)
- 30 Amp (Optional; 115/230 VAC)

* Note: If panel is wired for 230 VAC operation, Master Breaker must be 30 amp.

4) AC 7.5kW Ship/Shore Switch

5) DC Voltmeter

- 8 - 16 VDC (Standard)
- 16 - 32 VDC (Optional)

6) DC Ammeter

- 0 - 100 ADC (Standard)
- 0 - 50 ADC (Optional)

7) Breaker Values

Specify: 5, 10, 15, 20, 30, 40, 50 amp on illustration

8) Labels - Factory Installed

See catalog for choices - specify on illustration

ES-4 - Non-standard configuration modification fee:

\$75.00 Retail

ES-4SS - Non-standard configuration modification fee:

\$270.00 Retail

Extra circuit breakers: cost of breaker (see price list) plus \$1 each installed

General:

- Backlit meters with on-off switch
- Circuit "ON" indicator lights
- LS-III label set included
- Additional bus bar included
- Size: 17" W x 12" H x 4" D, Weight: 12 Lbs.

AC Section:

- 3-1/2" AC volt and amp meters
- AC master breaker
- Reverse polarity warning lights and lamp test
- 8 branch circuit capacity, 6 installed standard: 1-10A, 3-15A, 2-20A
- Amber circuit "ON" indicator lights

DC Section:

- 3-1/2" DC volt and amp meters
- 4 battery bank plus panel voltage test switch
- 20 branch circuit capacity, 16 installed standard; 3-5A, 3-10A, 5-15A, 5-20A
- Red circuit "ON" indicator lights

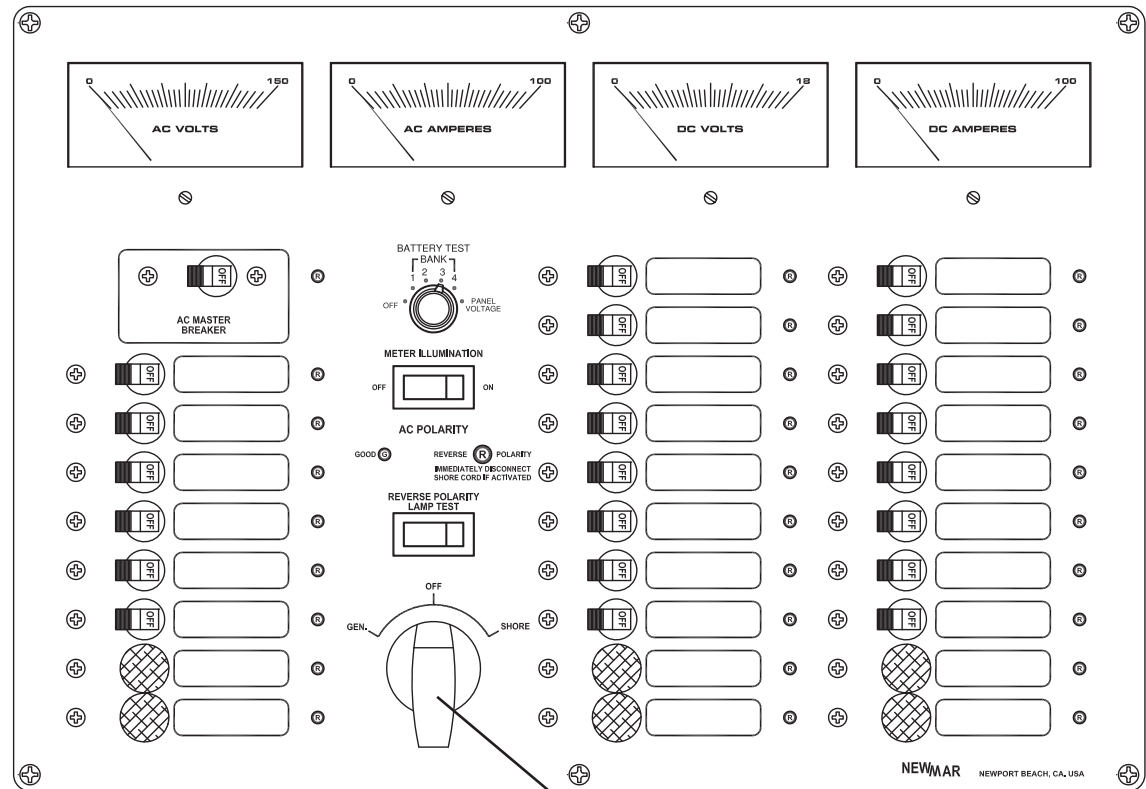

NEWMAR
 DC Power Onboard
 www.newmarpower.com

Optional

Rev. B