

AC Source Switches



SS-3.0



SS-7.5 INV

An AC source selector switch is an essential item for any boat with an onboard AC generator and/or inverter. The switch eliminates the safety hazard and/or damage that can occur if two AC sources are applied to the same circuit simultaneously.

These switches are fitted with a compact escutcheon plate with engraved switch position nomenclature (mounting dimensions below).

The switches carry UL and CSA approval, are CE marked, and feature heavy duty contacts and a positive step cam mechanism for low resistance contact closure. May be installed in panel with thickness up to 1/4".

Standard Switches

Model	Amperage @ 115/230	Number of Poles	Switch Positions	Standard Plate Markings**
SS-3.0	30	2	2 + "OFF"	SHIP-OFF-SHORE
SS-7.5	63	2	2 + "OFF"	SHIP-OFF-SHORE
SS-7.5 INV†	63	2	3 + "OFF"	OFF-GEN-INV-SHORE
SS-15*	126	2	2 + "OFF"	SHIP-OFF-SHORE

*May be configured as a 63 amp, 4 pole switch

† For vessels with onboard generator and inverter

Special Order Switches

If none of the standard switches listed above meet your requirements, NEWMAR will custom configure an AC selector switch for you. Please allow 2 weeks for shipment. Contact factory for pricing.

1) Determine the following:

- Amperage/kW rating required
- Number of switch positions required
- Number of poles required

2) Use the chart below to determine model number:

Amperage/kw Rating @ 120 VAC	2 Position Plus Off		3 Position Plus Off		4 Position Plus Off	
	2 Pole	3 Pole	2 Pole	3 Pole	2 Pole	3 Pole
63 Amp (7.5 kw)	S-622	S-632	S-623	S-633	S-624	S-634
80 Amp (10 kw)	S-822	S-832	S-823	S-833	S-824	S-834
100 Amp (12.5 kw)	S-1022	S-1032	S-1023	S-1033	S-1024	S-1034
125 Amp (15.5 kw)	S-1222	S-1232	S-1223	S-1233	S-1224	S-1234

Depth Dimensions

SS-3.0	2 1/8"
SS-7.5	2 3/8"
SS-7.5 INV	3 1/2"
SS-15	4"

Mounting Flange Dimensions

All standard switches, plus 63 and 80 amp special order switches. 100 and 125 amp special order switches only.

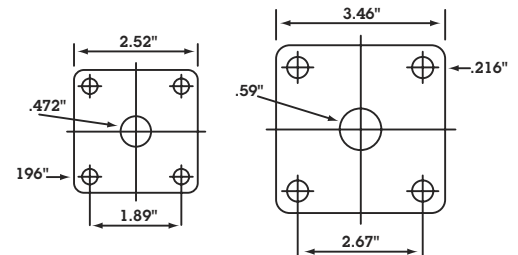

3) Select the desired switch selector position labeling from the following list:

SHORE GEN PORT SHORE PORT GEN
 SHORE 1 GEN 1 STBD SHORE STBD GEN
 SHORE 2 GEN 2 INV
 or specify the position labeling you require.

If you have need for a specific arrangement of the switch selector position labels, please mention this at the time of ordering. Note: Combination switches similar to one used in our ES-5 panel, (see page 17) also available. Contact factory for more information.

